

FOUNDATION & SURFACE BED LAYOUT  
SCALE 1:50

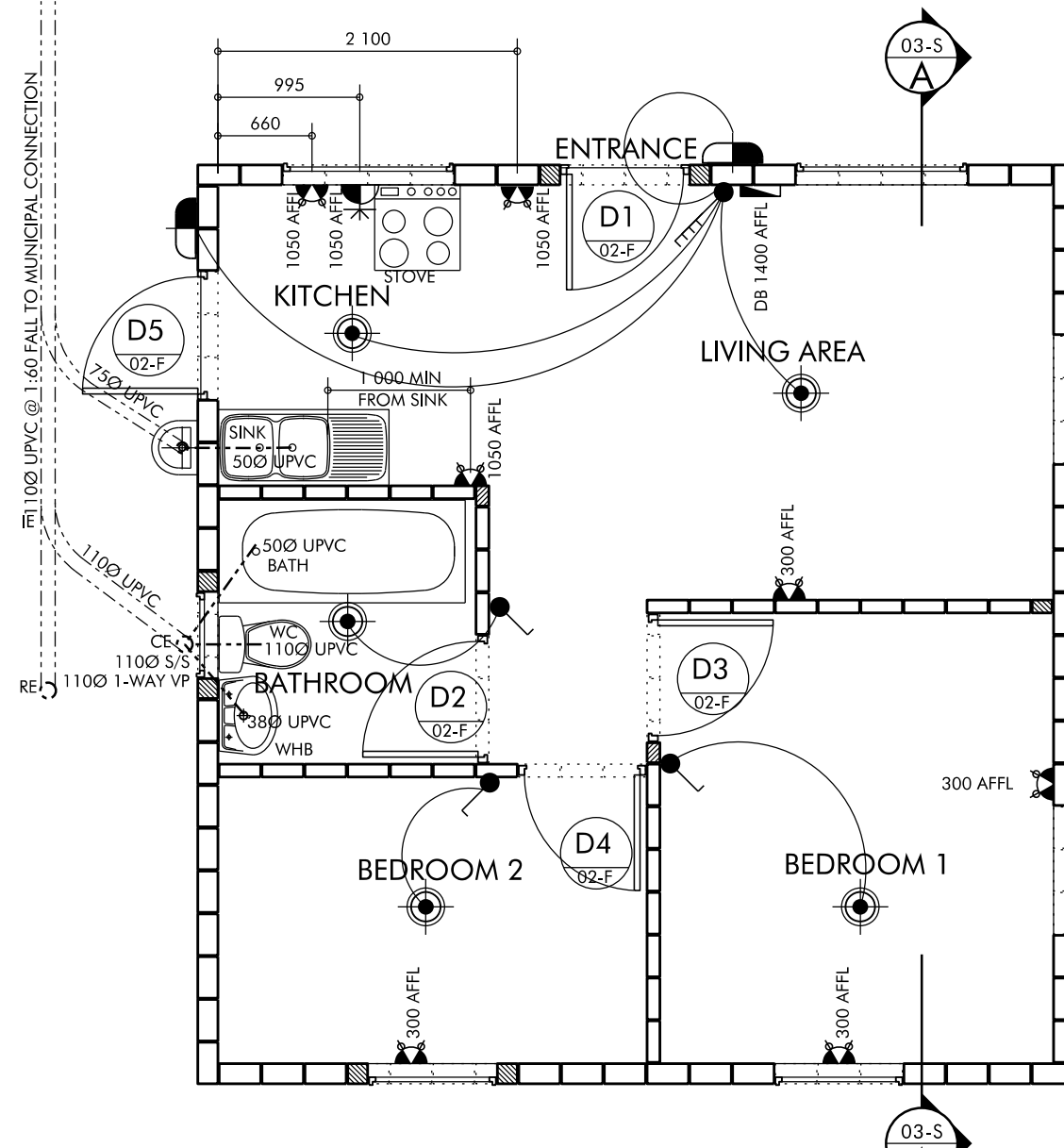

SUGGESTED SERVICES LAYOUT  
SCALE 1:50



D1	BETCRETE FRAME: BDF9/2100L
LH	EXTERNAL DOOR
	813x2032mm SOLID DOOR WITH WEATHERBAR. FINISH: PAINTED

D2	BETCRETE FRAME: BDF9/2100R
RH	BATHROOM DOOR
	813x2032mm HOLLOWCORE DOOR FINISH: PAINTED

D3	BETCRETE FRAME: BDF9/2100R
RH	BEDROOM DOOR
	813x2032mm HOLLOWCORE DOOR FINISH: PAINTED

D4	BETCRETE FRAME: BDF9/2100R
RH	BEDROOM DOOR
	813x2032mm HOLLOWCORE DOOR FINISH: PAINTED

D5	BETCRETE FRAME: BDF9/2100SR
RH	EXTERNAL DOOR (KITCHEN)
	813x2032mm STABLE DOOR WITH WEATHERBAR. FINISH: PAINTED
	NOTE: WINDOW TYPE W4 CAN BE USED IN STEAD OF THIS DOOR IF PREFERRED

DOOR SCHEDULE, SCALE 1:50

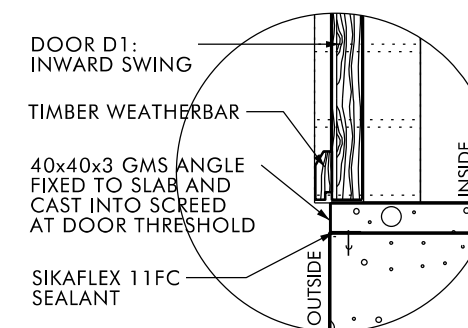

DETAIL 02, SCALE 1:10

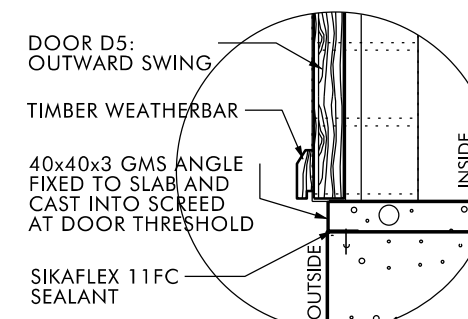

DETAIL 03, SCALE 1:10

revisions			
R	DATE	INIT	DESCRIPTION
A	20-09-11	ISIA	FIRST ISSUE FOR DISCUSSION
B	05-12-11	ISIA	DETAIL DEVELOPMENT
C	08-02-12	ISIA	DETAIL DEVELOPMENT

notes

ELECTRICAL LEGEND:

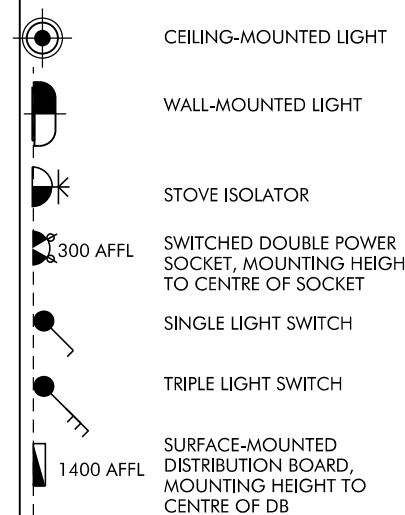

DRAINAGE NOTES:  
ALL PLUMBING, DRAINAGE WORK, AND INSTALLATION OF SANITARY FITTINGS TO COMPLY WITH SANS 10400 SECTIONS P & Q

MIN FALL TO ALL DRAINAGE PIPES TO BE 1:60

PROVIDE RE-SEAL TRAPS TO ALL WASTE FITTINGS

ACCESS TO BE PROVIDED TO ALL WASTE FITTINGS' I.E.'S

GROUND COVERAGE TO ALL UNDERGROUND PIPES TO BE MIN 400mm

BATH SIZE NOT TO EXCEED 1750x800mm

NOTE: ALL SERVICES TO BE CONNECTED TO MUNICIPAL CONNECTIONS

NOTE: SEE DISCLAIMER ON DRAWING 05-D

ALL DIMENSIONS TO BE CHECKED ON SITE PRIOR TO UNDERTAKING THE WORKS. DIMENSIONS NOT TO BE SCALED FROM THIS DRAWING.

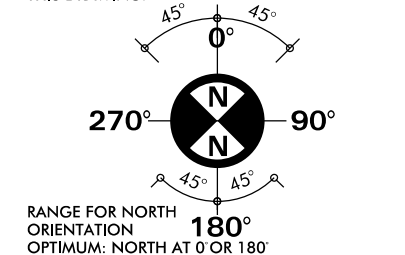

PROJECT	PROPOSED CMA HOUSE TYPE B - INLAND - 39.5m <sup>2</sup>		
	Proposed New Residence for _____		
	Erf _____		
TITLE	FOUNDATION LAYOUT SERVICES LAYOUT DOOR SCHEDULES		
DRAWN	DATE:	SCALE:	JOB NO:
ISIA	SEPT'11	AS SHOWN	11-02
DWG. NO:	02-F		REV. C